



## 2/1 Kilvington Court Berwick VIC

4 2 2

Situated in the highly sought-after pocket of Olde Berwick, just seconds away from the renowned Akoonah Park & Berwick Market, this north-east facing 4-bedroom, 2-bathroom residence is a true sanctuary that has been meticulously maintained.

**Type** : House

**Price** : \$935,000 - \$985,000

**View** : <https://www.yere.com.au/sale/vic/south-east/berwick/residential/house/8136727>

Thoughtfully and custom designed from top to bottom, this home seamlessly blends Hamptons and Parisian style living, offering the perfect combination of tranquility and convenience with vibrant local amenities and lush parklands right at your doorstep.

What Makes This Home Special:

Spacious Living: Two generous living areas designed for

[For full version visit the website](#)



**Rachhpal Singh**  
03 8578 5700

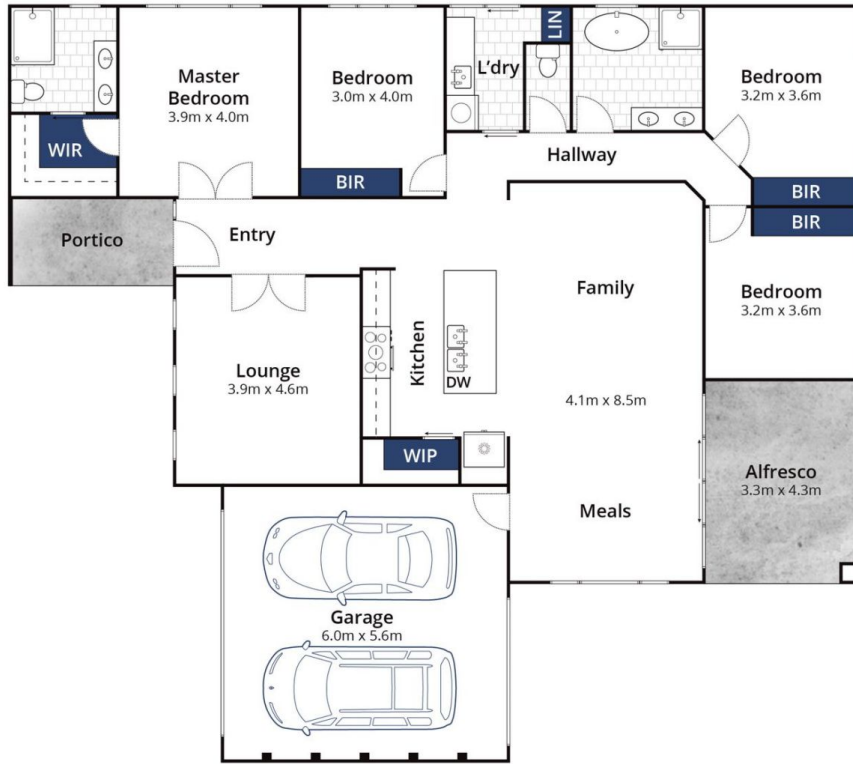

Whilst [bwrn.com.au](http://bwrn.com.au) has made every attempt to ensure the accuracy of the floor plan contained here, measurements are approximate and no responsibility is taken for any error, omission, or mis-statement. This plan is for illustrative purposes only.

**2/1 Kilvington Court, Berwick**

**YE YOUR EXPERT**