

37 County Drive Berwick VIC

4  2  2 

Nestled in the heart of Berwick, a vibrant and family friendly suburb, 37 county drive will make your dreams of a perfect home come true. This stunning residence is about to hit the market, offering a blend of comfort, style, and a fantastic location.

Step into a spacious and thoroughly maintained interior designed for modern living. The open-plan layout creates an easy flow between the living, dining and kitchen areas. Oversized windows saturate the space in natural light, giving it an inviting and warm ambiance.

The living area is spacious and inviting with a fireplace, contemporary kitchen and dining space that flows seamlessly to the outdoor area. The house includes ducted

Type : House
Price : \$ 886,000
Land Size : 754 sqm
View : <https://www.yere.com.au/sale/vic/south-east/berwick/residential/house/7727028>



Lin Zhang
03 8578 5700



Arif Akhlaqi
03 8578 5700

[For full version visit the website](https://www.yere.com.au)

FLOOR PLAN



SITE PLAN

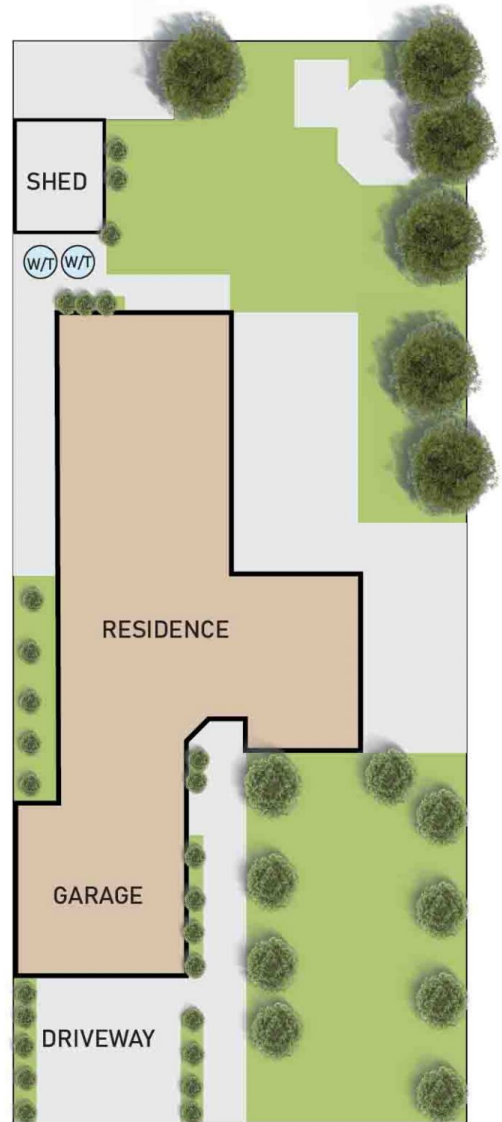

37 COUNTY DRIVE, BERWICK

* DIMENSIONS ARE APPROXIMATE AND FOR ILLUSTRATIVE PURPOSES ONLY

YE YOUR EXPERT