

6 Phoenix Avenue Cranbourne VIC

4 2 2

This beautifully designed 4-bedroom single storey ex-display home well situated in the highly popular Park Avenue Estate, Cranbourne offers a perfect blend of modern luxury and comfortable living. Located in a desirable neighbourhood, this property is a testament to style, functionality, and convenience.

This home offers a contemporary façade and landscaped gardens welcome you inside with a wide entrance. This immaculate home is positioned on a neat 660sqm block of land and is filled with plenty of upgrades and features. Live the lifestyle of your dreams in this stunning family home offering three generous sized bedrooms plus study/ 4th bedroom. Spacious master bedroom features a WIRs & ensuite and double vanity with stone benchtop.

[For full version visit the website](https://www.yere.com.au)

Type : House
Price : \$ 805,000
Land Size : 660 sqm
View : <https://www.yere.com.au/sale/vic/south-east/cranbourne/residential/house/7726046>



Megha Dhingra
03 8578 5700



Rick Kothari
03 8578 5700



Floor Plan

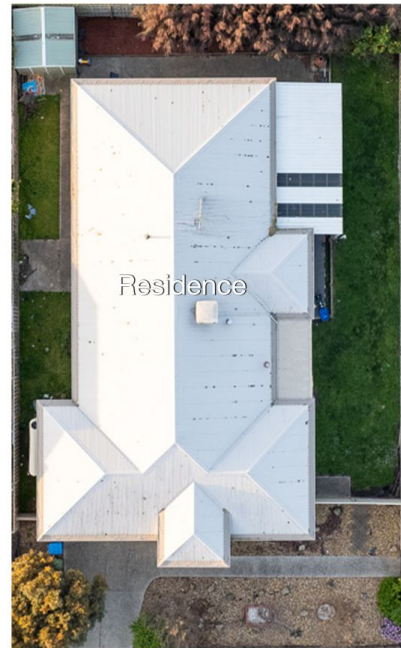

Site Plan

The floor plan is not to scale. Areas and dimensions are approximate and therefore plan should only be used for illustrative purposes