

## 22 County Drive Berwick VIC

3 2 2

Welcome to 22 Country Drive, Berwick !

Situated in one of Berwick's most sought after locations, this is a rare opportunity to purchase this beautiful family home with unlimited scope to value add. Featuring a fantastic floorplan which includes living area and kitchen with dining area, 3 bedrooms (master with en-suite and WIR), 2 bathrooms, double lock up garage, plus beautiful Alfresco to entertain friends and families and fully fenced front yard to complete this great family home.

The kitchen has been meticulously designed with quality stainless steel appliances, electric cooktop, dishwasher, marble bench top and splashback and good storage space.

[For full version visit the website](https://www.yere.com.au)

**Type** : House  
**Price** : \$ 770,000  
**Land Size** : 651 sqm  
**View** : <https://www.yere.com.au/sale/vic/south-east/berwick/residential/house/7590996>



**Lin Zhang**  
03 8578 5700



**Arif Akhlaqi**  
03 8578 5700

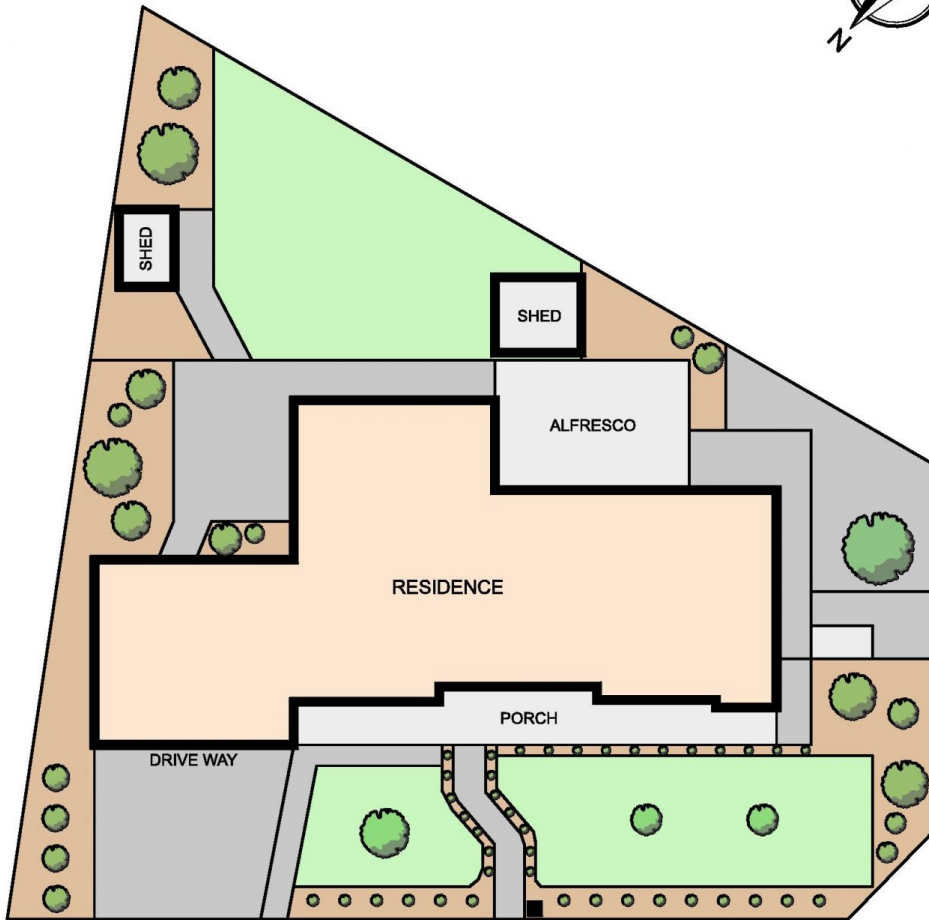

SITE PLAN



GROUND FLOOR

## 22 County Drive, Berwick

\*Dimensions are approximate and for illustrative purposes only