

18/2 Greenfield Drive Clayton VIC

2 1 1

Conveniently located within walking distance to Monash University, Monash Hospital, Princes Highway and with Clayton Shops and Clayton Station at your doorstep, this outstanding residence is ideal for the astute investor looking for a long term rental and can enjoy the benefits of a set and forget property.

Spacious throughout with light filled living this 2 bedroom residence enjoys open plan living and is further complemented with single carport, two way bathroom and an expansive balcony overlooking the communal swimming pool.

Creature comforts include:

Type : Apartment

Price : \$ 380,000

View : <https://www.yere.com.au/sale/vic/east/clayton/residential/apartment/7290401>



Lin Zhang
03 8578 5700



Seb Jean-Pierre
03 8578 5700

[For full version visit the website](https://www.yere.com.au)

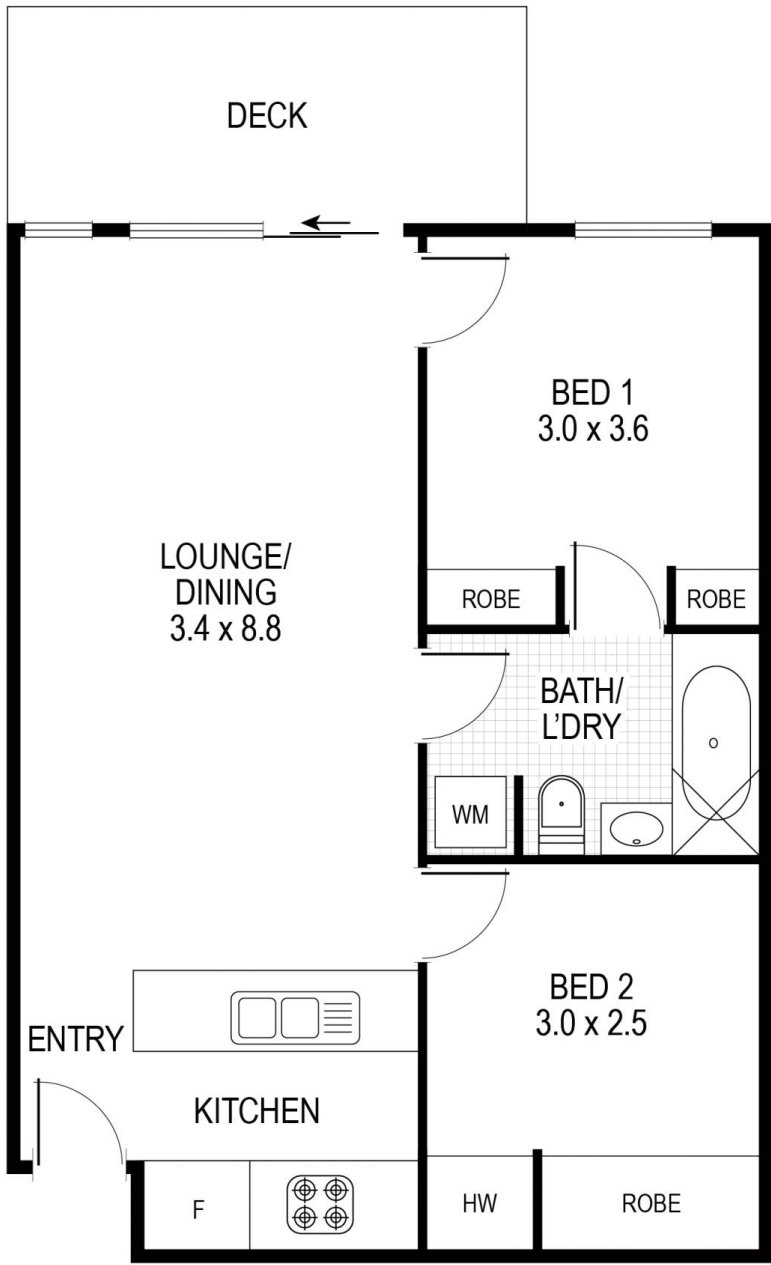

(NOY IN POSITON)

18/2 Greenfield Dve, Clayton

