



1 Kendall Drive Narre Warren VIC

3 2 2

Nestled away in the evergreen Maramba Estate, this home is sure to impress a family who appreciates location & carefree living. Not only are you a stone's throw away to Mary Mackillop Primary School and a short drive to the popular Westfield Fountain Gate Shopping Center, You will experience true convenience while easily accessing the M1 Freeway & access an abundance of Flora in the area.

As you walk into the home after passing the low maintenance front yard, you will be greeted by the home's clever layout sure to suit your lifestyle. The kitchen is well appointed with a great view to the decking area, where you will have the freedom to host many of the family events you've been dreaming of.

Type : House
Price : \$ 710,000
Land Size : 644 sqm
View : <https://www.yere.com.au/sale/vic/south-east/narre-warren/residential/house/7250106>



Lin Zhang
03 8578 5700



Seb Jean-Pierre
03 8578 5700

[For full version visit the website](https://www.yere.com.au)



GROUND FLOOR



SITE PLAN

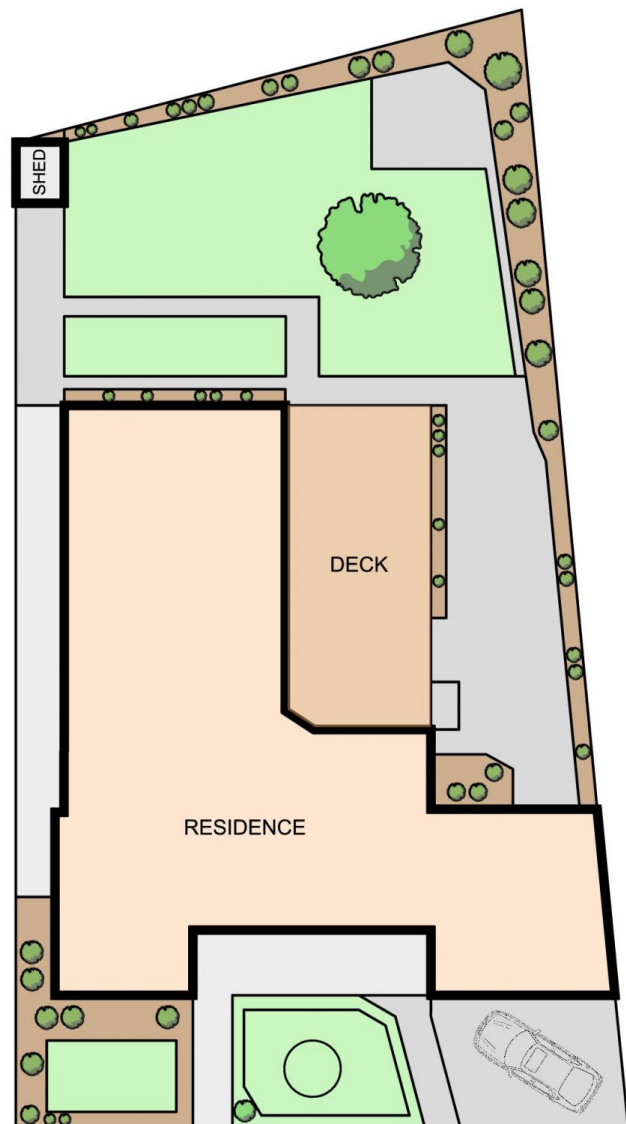

1 Kendall Drive, Narre Warren

*Dimensions are approximate and for illustrative purposes only