



27 Boyce Circuit Clyde North VIC

4 2 1

Located in the highly sought-after New Meridian Estate and close to the Hillcrest College, St Francis Xavier College, Chisholm TAFE, Federation University, Casey Hospital, St Johns of God Hospital, other local quality schools, Monash Freeway, Eden Rise Shopping Centre, Berwick Train Station, Medical Centres, Child Care Centres, Local Parks, Lakes and all other amenities is this beautiful brand new home proudly boasting: -

4 bedrooms, master with full ensuite and WIR
Spacious kitchen with quality appliances and plenty of storage space
Open plan living/dining area to entertain families and friends throughout the year
Single lock up garage with the remote and internal access

Type : House
Price : \$ 630,000
View : <https://www.yere.com.au/sale/vic/south-east/clyde-north/residential/house/7154579>



Rachhpal Singh
03 8578 5700



Megha Dhingra
03 8578 5700

[For full version visit the website](https://www.yere.com.au)

↑
NORTH

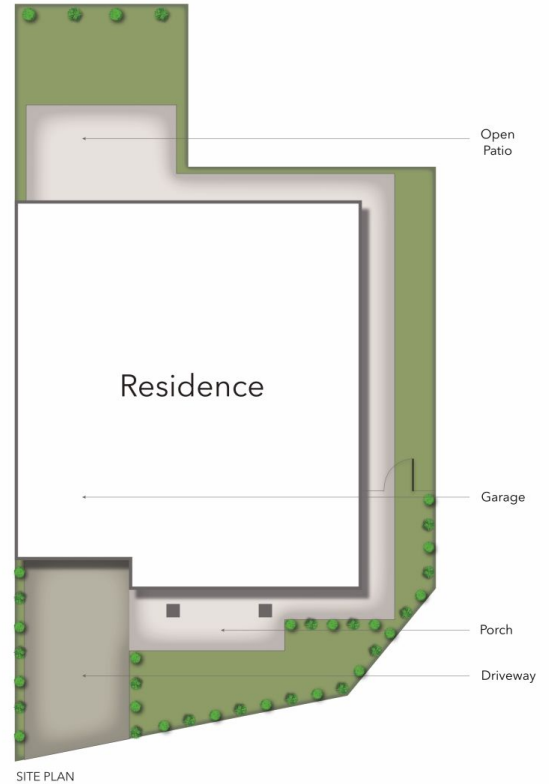

27 Boyce Circuit CLYDE NORTH

4 Bed 2 Bath 3 Car



While every attempt has been made to ensure the accuracy of the floor plan contained here, measurements of doors, windows, rooms and any other items are approximate and no responsibility is taken for any error omission or miss measurement. this plan is for illustrative purposes only and should be used as such by any prospective purchaser.