



### 3 Ridgmont Drive Berwick VIC

4 2 2

Located only stone throw away from the Eden Rise shopping centre, local bus stops, medical centres and only short drive to the quality schools, Chisholm TAFE, Federation university, Monash freeway, Casey hospital, local parks, walkways and all other amenities is this beautiful home proudly boasting: -

**Land Size** : 646 sqm  
**View** : <https://www.yere.com.au/lease/vic/south-east/berwick/residential/house/7094842>

4 bedrooms, master with full ensuite and WIR  
Spacious kitchen with quality appliances and walk in pantry  
3 living areas including the formal lounge, family and rumpus plus the separate dining area  
Double lock up garage with internal and remote access

Extras include: - gas ducted heating, split system air conditioner, dishwasher, timber floor, outdoor alfresco, quality curtains, blinds, light fittings and much more



**Winnie Zhou**  
**03 8578 5700**

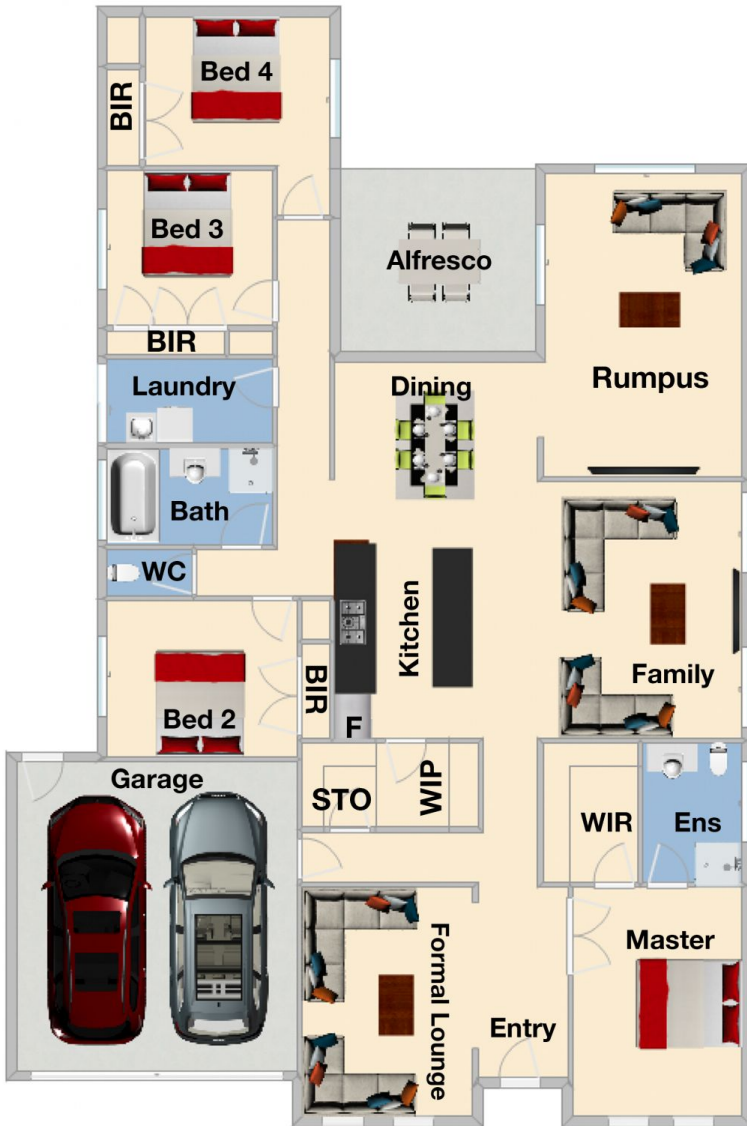

Floor Plan



Site Plan