



11 Sullivans Walk Keysborough VIC

3 2 2

Absolutely stunning, this very modern townhouse in the Krystal Estate presents an amazing lifestyle/investment opportunity with its split-level floorplan, distinctive features and profusion of natural light throughout. Impressive from every perspective, the home's adaptable interior showcases a large master bedroom with built-in robes, private ensuite with double vanity and split system at ground level. The 2nd level showcases two additional bedrooms both with in-built robes, split system comfort and stylish main bathroom. The stunning kitchen boasts stainless steel gas appliances including a cooktop, oven, dishwasher and stone benchtops. Highlighted by a very comfortable lounge and dining zone with abundant natural light, as well as an adjoining huge balcony that's relaxing.

Type : Townhouse

Price : \$ 670,000

View : <https://www.yere.com.au/sale/vic/south-east/keysborough/residential/townhouse/6953206>



Samir Pabari
03 8578 5700



Saloni Lalseta
03 8578 5700

[For full version visit the website](#)

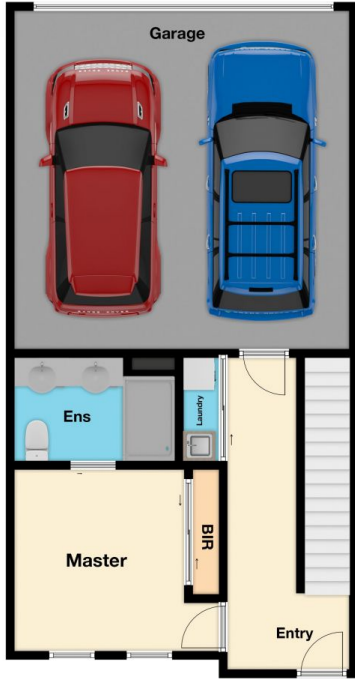

Ground Floor



First Floor



Site Plan

The floor plan is not to scale. Areas and dimensions are approximate and therefore plan should only be used for illustrative purposes