

27 Barossa Drive Clyde North VIC

4 2 2

Located within walking distance to the Selandra Rise Shopping Centre, Selandra Community Hub, Quality Schools, Medical Centres, Child Care Centres, Local Parks, Public Transport and all other amenities is this beautiful family home proudly boasting:-

4 Bedrooms, master with full ensuite and WIR
Spacious kitchen with quality appliances, stone benchtops, dishwasher and plenty of storage space
2 living areas including the formal lounge and family plus a separate dining area
Double lock up garage with internal access

Extras include:- gas ducted heating, split system air conditioner, brand new carpets, freshly painted, brand new

[For full version visit the website](https://www.yere.com.au/sale/vic/south-east/clyde-north/residential/house/6790349)

Type : House
Price : \$ 702,500
Land Size : 420 sqm
View : <https://www.yere.com.au/sale/vic/south-east/clyde-north/residential/house/6790349>



Rachhpal Singh
03 8578 5700



Megha Dhingra
03 8578 5700



Floor Plan

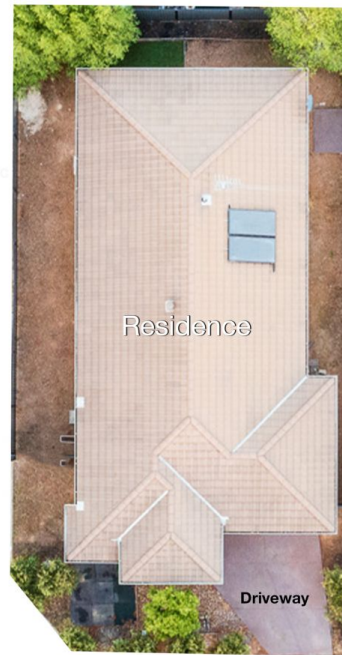

Site Plan

The floor plan is not to scale. Areas and dimensions are approximate and therefore plan should only be used for illustrative purposes