



91 Strathavan Drive Berwick VIC

3 1 1

This recently renovated house has a huge lounge with brand new central gas ducted heating, reverse cycle A/C, separate meals area, 3 spacious bedrooms and a central bathroom. The kitchen is fully updated with gas cooking, oven, and ample of storage.

A beautiful big backyard perfect for entertaining family and friends. Regular lawn mowing is included which is an added bonus. Single car garage along with space to park an extra car on the driveway.

Located so close to Casey Hospital, Brentwood Park Primary School, Kambrya College, Beaconsfield College, Berwick Primary School, Beaconsfield Train Station, Berwick Train Station, freeway access, walking tracks and much more.

[For full version visit the website](https://www.yere.com.au/lease/vic/south-east/berwick/residential/house/6498771)

Type : House

View : <https://www.yere.com.au/lease/vic/south-east/berwick/residential/house/6498771>



Saloni Lalseta
03 8578 5700

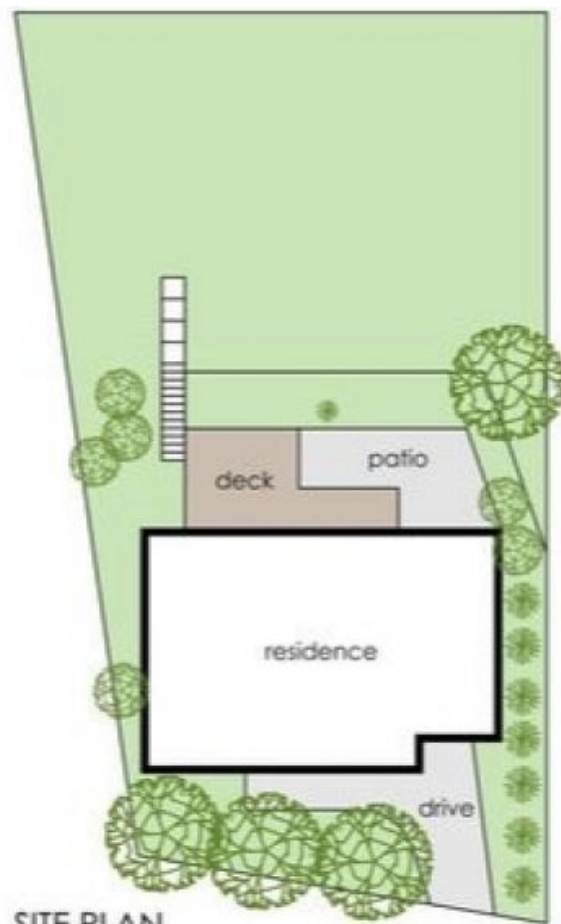

SITE PLAN

