

## 731 Princes Highway Berwick VIC

3 1 2

Located in one of the prime location in Berwick is this well-built home sits on a generous block size of 841sqm comes with the opportunity to subdivide now or in future, current zoning is general residential zone 2 which allows to build apartment buildings up to 11.5 metres tall, units, townhouses, medical centre, child care centre, car wash, convenience restaurant, convenience shop, leisure and recreation, store, take away food premises and the list just keep going (STCA). Current house is in a good condition so you can either move in or rent out the property till the time you are ready for the subdivision or simply let the property grow in value and reap the rewards later. The property is close to the quality schools, Federation university, Chisholm TAFE, Berwick village, Fountain Gate shopping centre, local parks, bus stops, Berwick and Narre

**Type** : House  
**Price** : \$ 855,000  
**Land Size** : 841 sqm  
**View** : <https://www.yere.com.au/sale/vic/south-east/berwick/residential/house/6462518>



**Rachhpal Singh**  
03 8578 5700



**Samir Pabari**  
03 8578 5700

[For full version visit the website](https://www.yere.com.au)

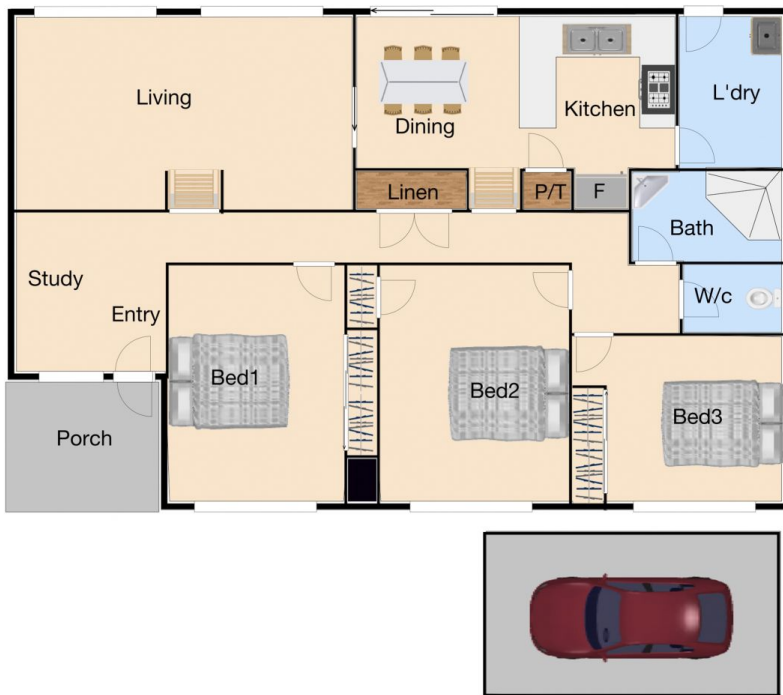

**Floor Plan**

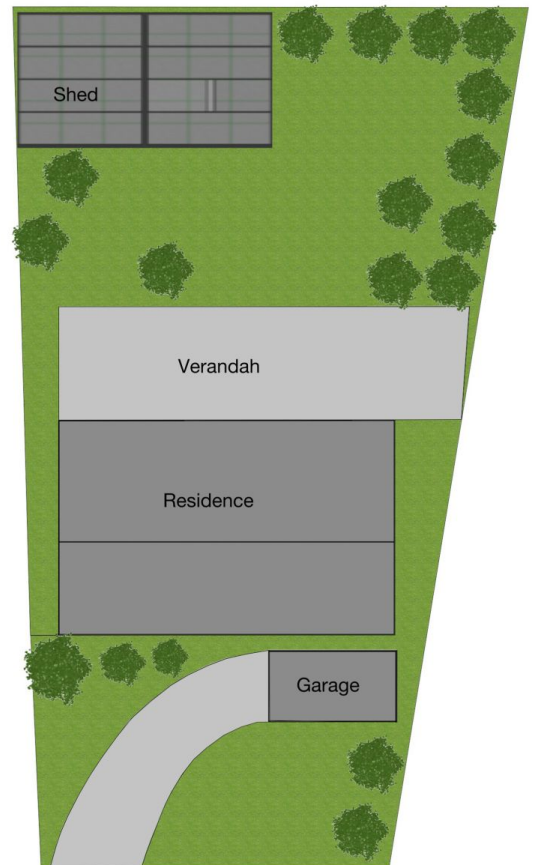

**Site Plan**