



67 Everard Avenue Clyde North VIC

4  3  2 

Located close to St Peter's college, Wilandra Rise primary school, Clyde primary school, Selandra Rise shopping centre, Shopping on Clyde, Cranbourne and Berwick train station, Monash freeway, local bus stops, parks, medical centres, childcare centres, kindergartens and all other amenities is this beautiful luxurious house proudly boasting:

Type : House

Price : \$ 850,000

View : <https://www.yere.com.au/sale/vic/south-east/clyde-north/residential/house/6337007>

4 bedrooms plus study, master with full ensuite, his and her WIR's, another guest bedroom with attached ensuite and third bathroom to cater the other two bedrooms
Open plan kitchen with butler's pantry, double oven, dishwasher, high end appliances, island waterfall stone benches, glass splashback and plenty of storage space
2 living areas including the formal lounge and family plus



Rachhpal Singh
03 8578 5700



Megha Dhingra
03 8578 5700

[For full version visit the website](https://www.yere.com.au)



Floor Plan

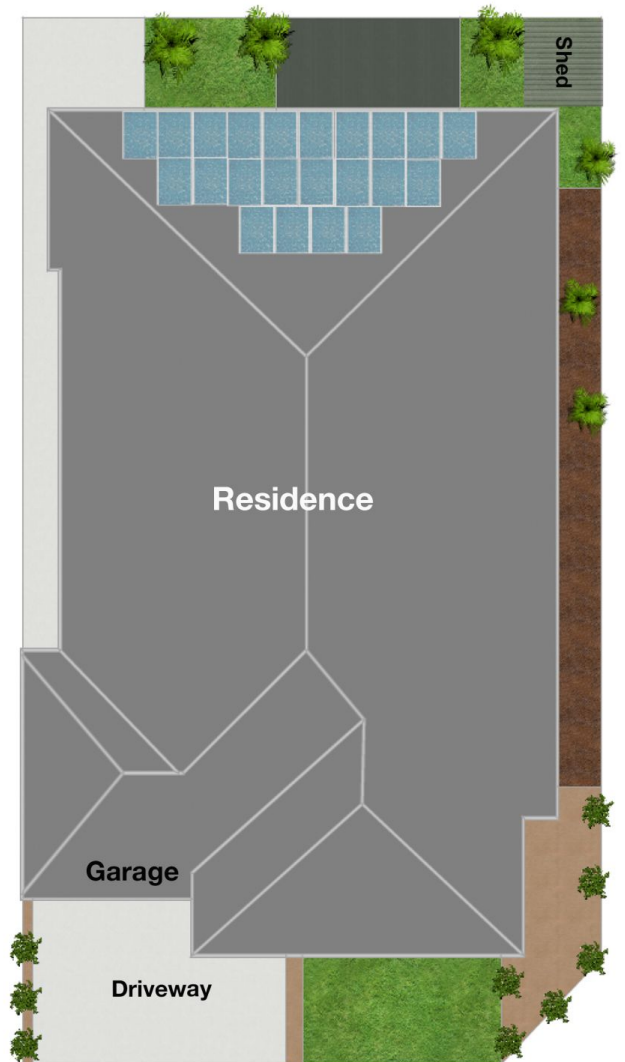

Site Plan

