



## 22 Beechtree Way Cranbourne North VIC

5 3 4

Located in the highly prestigious The Avenue Estate and close to Tulliallan primary school, Hillsmeade primary school, Chisholm TAFE, Federation university, Monash freeway, Berwick and Narre Warren train station, The Avenue shopping centre, Eden Rise shopping centre, Casey Central shopping centre, Fountain Gate shopping centre, bus route 847, 899, local parks, lakes, walkways, bicycle tracks, child care centres, kindergartens, medical centres, Casey hospital, St John of God hospital and all other amenities is this grand majestic house proudly boasting:-

5 bedrooms plus study, master on the ground floor with full ensuite and WIR's  
Spacious kitchen with quality appliances, walk in pantry

[For full version visit the website](https://www.yere.com.au)

**Type** : House  
**Price** : \$ 855,000  
**Land Size** : 603 sqm  
**View** : <https://www.yere.com.au/sale/vic/south-east/cranbourne-north/residential/house/5717986>



**Sean Singh**  
0468 491 676



**Asif Raees**  
03 8578 5700



Ground Floor



Upper Floor

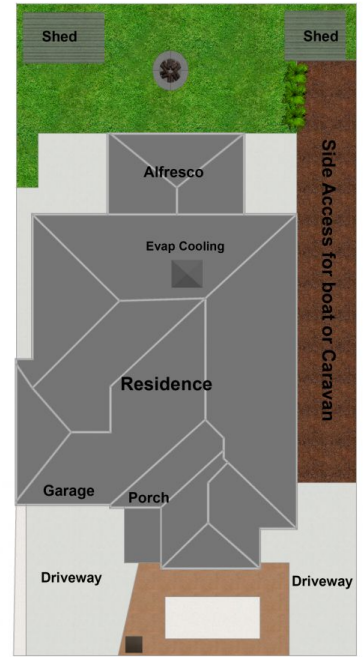

Site Plan



The floor plan is not to scale. Areas and dimensions are approximate and therefore plan should only be used for illustrative purposes