

4 Montpelier Drive Berwick VIC

4 2 2

Nestled amongst the lofty homes in the leafy avenues and boulevards of prestigious Chase Estate in Berwick is this spacious 4-bedroom home. Fresh as a pin, the whole family can enjoy a space of their own and a place to call home.

This beautiful family home proudly boasts: -

- Central kitchen, the hub of the home with granite benchtops, glass splashbacks and stainless appliances
- Naturally lit spacious family/meals area opening onto an alfresco area and lawned backyard
- Master bedroom with ensuite, double vanity and walk in robe
- Home office

[For full version visit the website](https://www.yere.com.au)

Type : House
Price : \$ 736,000
Land Size : 578 sqm
View : <https://www.yere.com.au/sale/vic/south-east/berwick/residential/house/5717975>



Rachhpal Singh
03 8578 5700



Megha Dhingra
03 8578 5700

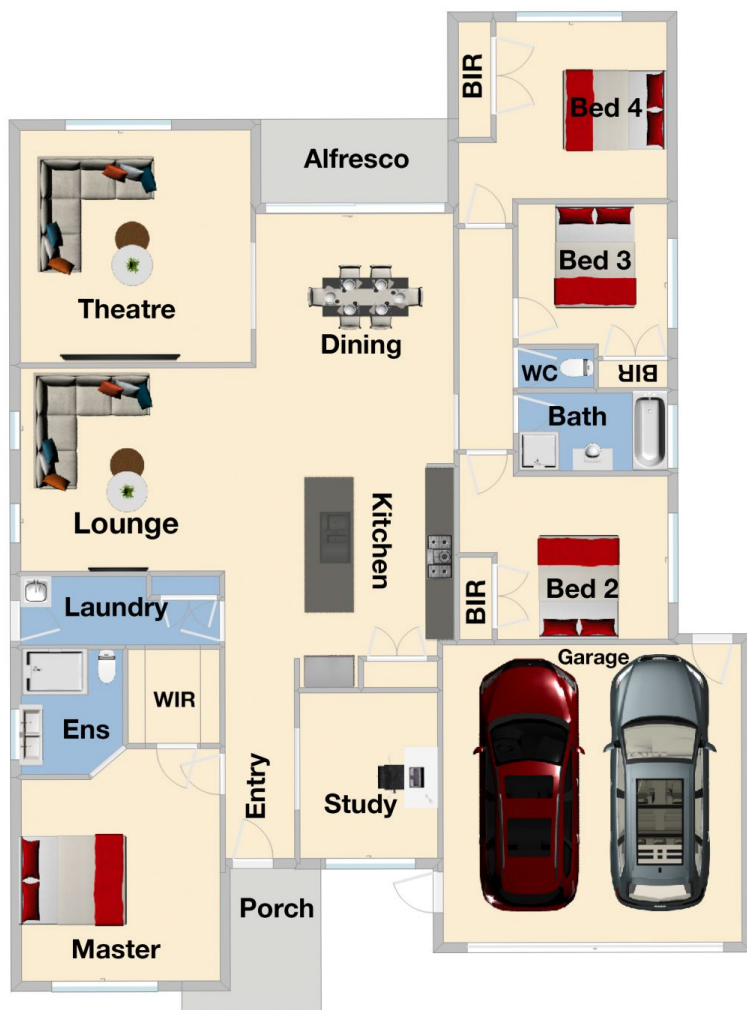

Floor Plan

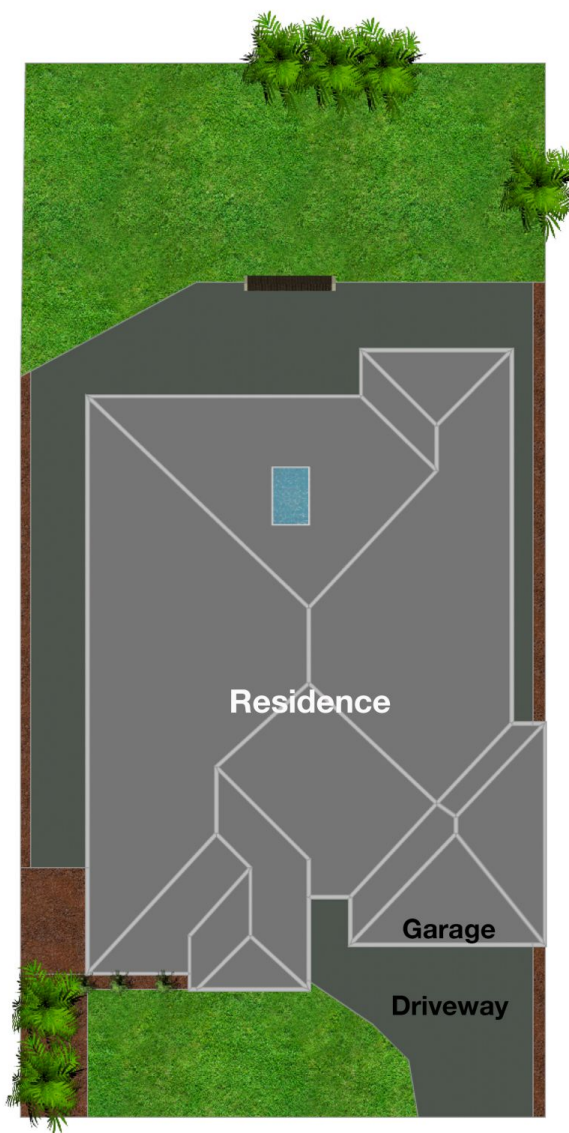

Site Plan