



9 Portrait Place Clyde North VIC

3 2 2

Located within the walking distance to the St Peters college, St Thomas the Apostle catholic primary school, Wilandra Rise primary school, Shopping on Clyde, Casey medical centre Clyde, bus route 796 and 897, Heritage Park, Pasadena Park and 5-10 minutes' drive to the Cranbourne train station, Casey Fields football ground, Casey Race aquatic centre, South Gippsland highway, Monash freeway, kindergartens, child care centres and all other amenities is this beautiful modern home proudly boasting:-

3 bedrooms, master with full ensuite and WIR
Gourmet kitchen with window splashback, waterfall stone benchtops and high-quality European Ariston appliances, as featured on Master Chef

Type : House
Price : \$ 552,500
View : <https://www.yere.com.au/sale/vic/south-east/clyde-north/residential/house/5717974>



Rachhpal Singh
03 8578 5700



Megha Dhingra
03 8578 5700

[For full version visit the website](https://www.yere.com.au)



Ground Floor

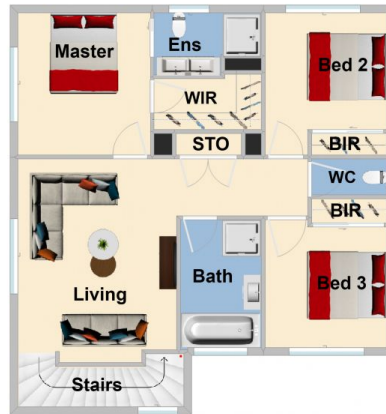

Upper Floor

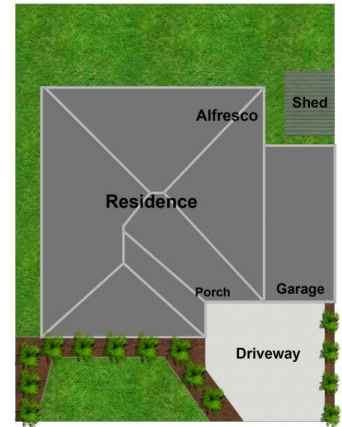

Site Plan



The floor plan is not to scale. Areas and dimensions are approximate and therefore plan should only be used for illustrative purposes