



4 Mahal Drive Clyde North VIC

4 🚗 2 🚗 2 🚗

Located in the highly sought after Highgrove Estate, close to the Wilandra Rise primary school, St Thomas the Apostle Catholic primary school, St Peter's college, Shopping on Clyde, Selandra Rise shopping centre, Casey medical centre, Shalom medical centre, local bus stops, Cranbourne train station, Berwick train station, Monash freeway, local parks, walkways and all other amenities is this beautiful family home proudly boasting:-

4 bedrooms, master with full ensuite and WIR
Spacious kitchen with quality appliances and plenty of storage space
2 living areas including the formal lounge and family plus the separate dining area
Double lock up garage with internal and remote access

[For full version visit the website](https://www.yere.com.au)

Type : House
Price : \$ 591,000
Land Size : 441 sqm
View : <https://www.yere.com.au/sale/vic/south-east/clyde-north/residential/house/5717947>



Rachhpal Singh
03 8578 5700

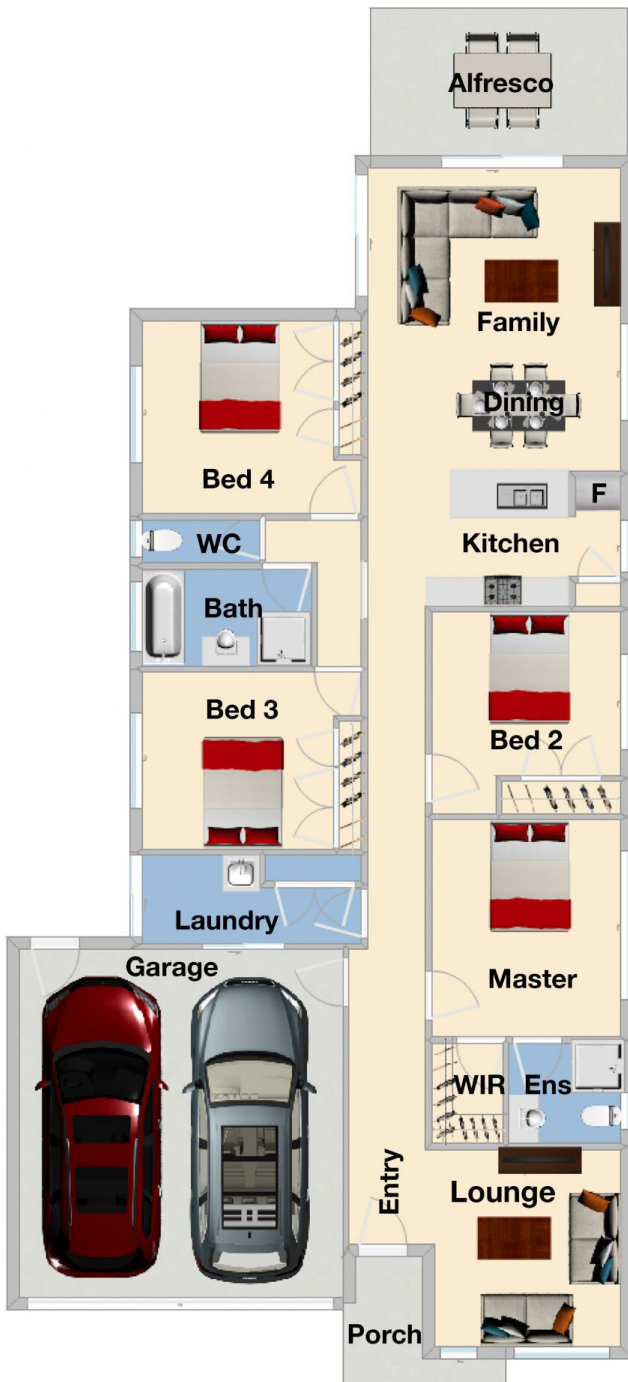

Floor Plan

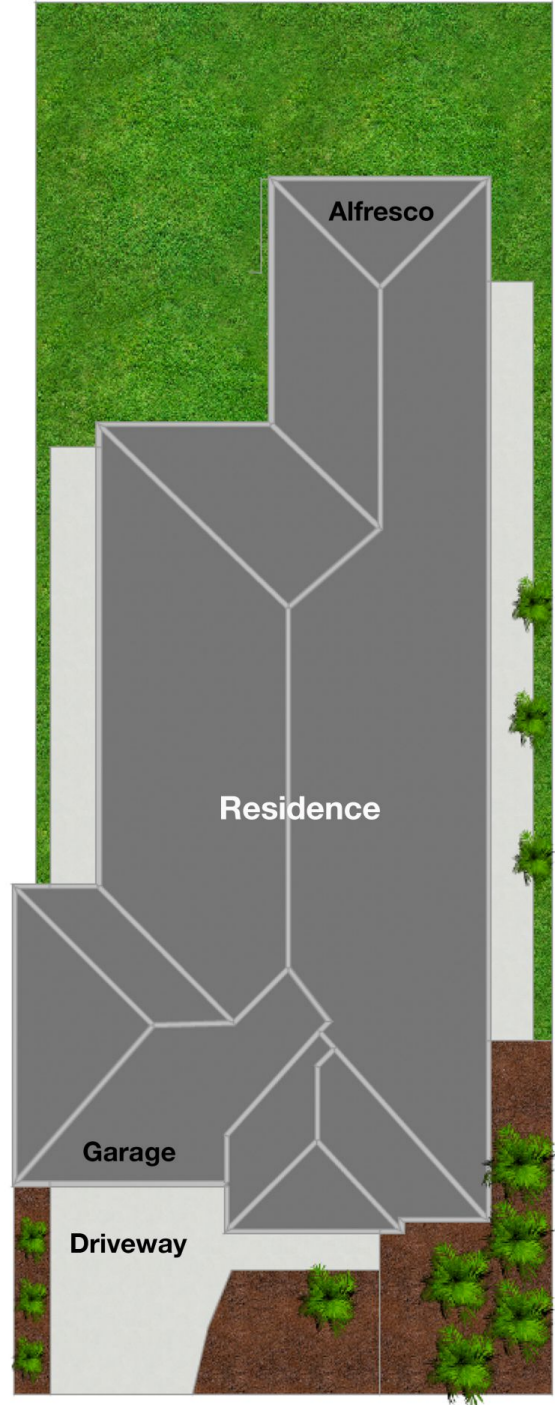

Site Plan