



12 Coolana Drive Clyde North VIC

4 2 2

Located in one of the prime location in Berwick Waters Estate and within the walking distance to the local parks, walkways, bus stops, kindergartens, child care centres, Hillcrest college and within 5-10 minutes' drive to the quality schools, Chisholm TAFE, Federation university, Berwick train station, Monash freeway, Casey hospital, St John of God hospital, medical centres, Eden Rise shopping centre and all other amenities is this beautiful family home proudly boasting:-

4 bedrooms, master with full ensuite and WIR
Spacious kitchen with quality appliances and walk in pantry
Open plan living/dining area which further opens out to the undercover alfresco with large timber deck
Double garage with internal and remote access

Type : House
Price : \$ 622,000
View : <https://www.yere.com.au/sale/vic/south-east/clyde-north/residential/house/5717941>



Rachhpal Singh
03 8578 5700



Sean Singh
0468 491 676

[For full version visit the website](https://www.yere.com.au)

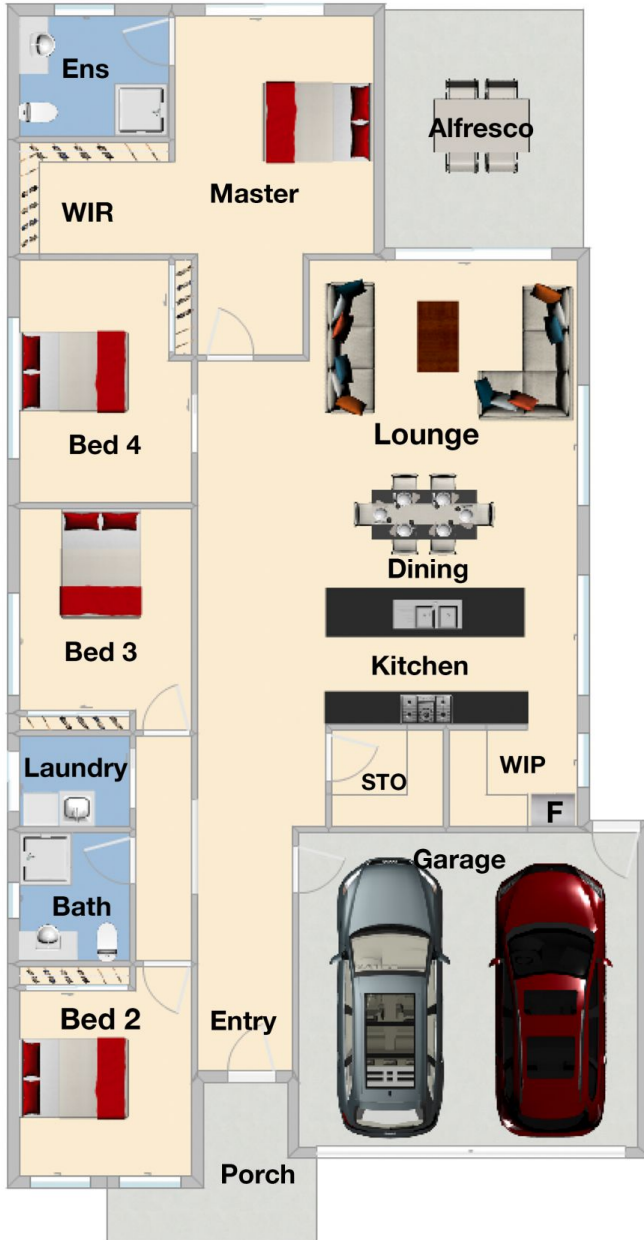

Floor Plan

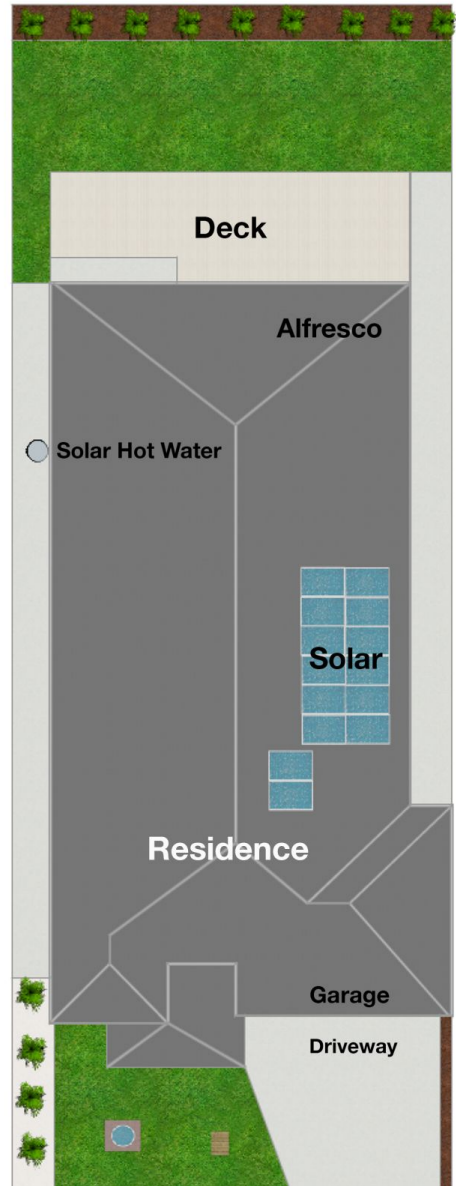

Site Plan