



## 6 Flora Court Cranbourne North VIC

4 2 2

Located close to the Courtenay Gardens primary school, Lyndhurst secondary college, St Therese's primary school, Cranbourne Park shopping centre, Lynbrook shopping centre, Merinda Park train station, Lynbrook train station, Monash freeway, local bus stops, parks, child care centres, medical centres and all other amenities is this beautiful family home proudly boasting: -

**Type** : House  
**Price** : \$ 620,000  
**Land Size** : 702 sqm  
**View** : <https://www.yere.com.au/sale/vic/south-east/cranbourne-north/residential/house/5717926>

4 bedrooms plus study nook, master with full ensuite and WIR's  
Spacious kitchen with quality appliances and plenty of storage space  
2 living areas including the formal lounge and family plus the separate dining area  
Double lock up garage with remote and rear access

[For full version visit the website](https://www.yere.com.au)



Site Plan



Ground Floor

Floor Plan

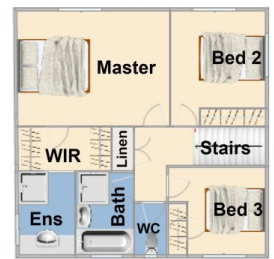

Upper Floor

The floor plan is not to scale. Areas and dimensions are approximate and therefore plan should only be used for illustrative purposes